

# MODEL Ix 24

Standard Run **MSRP \$69,314**

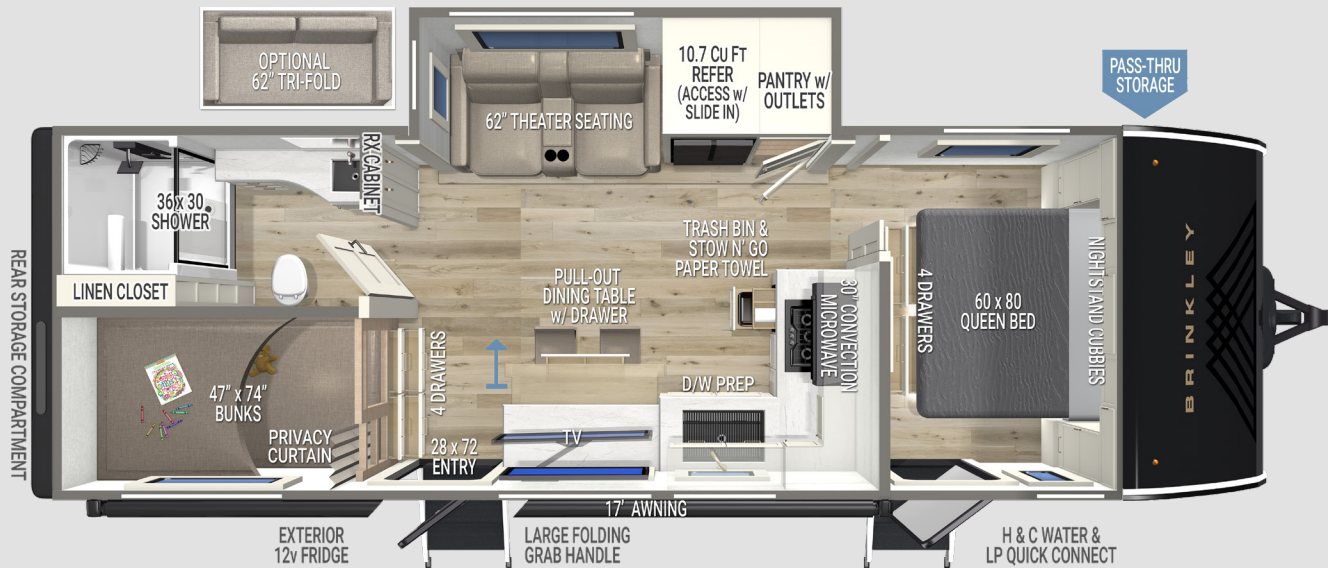

## SPECIFICATIONS

- UVW: 6,891 lbs.
- GVWR: 8,495 lbs.
- Hitch Weight: 654 lbs.
- Exterior Length: 29' 11"
- Overall Height w/ A/C: 11' 1"
- Width: 96"
- Interior Height: 78"
- Slide Height: 69"
- Axles: Tandem 4,400 lbs.
- Wheels & Tires: 15" Load Range E (10-Ply)
- Fresh Water Capacity: 46 gal.
- Gray Water Capacity: 80 gal.
- Black Water Capacity: 44 gal.
- Insulation: Floors/Ceiling R40, Walls R9

## FEATURES

- Fiberglass Front Cap
- 40" Smart TV w/ Articulating Mount
- 62" Wall Hugger Theater Seating w/ 2x Recliners
- Solid Surface Countertops (Kitchen)
- Large Farmhouse Stainless Steel Sink w/ Tuff Coat & Roller Cover
- Dishwasher Prep
- Pull-Out Dining Table w/ 2x Folding Chairs
- Pull-Out Trash Bin w/ Utility Storage & Integrated Stow 'n Go" Paper Towel Caddy
- Large Pantry w/ Appliance Outlet
- Premium Residential Cabinets & Drawers w/ Dovetail Joints
- Brinkley CraftSense™ Wood Trim Construction
- Queen Bed w/ Residential 7" Memory Foam Mattress (60"x80")
- Dual Bedside Wardrobes & Nightstand Cubbies w/ Outlet (CPAP Ready)
- 18k Chill Cube A/C w/ Heat Pump (Ducted)
- Second A/C Prep in Bedroom
- Double Mattress Bunks (47"x74") w/ Privacy Curtains
- One-Piece 36"x30" Fiberglass Shower
- Square Euro Frameless Windows w/ Up To 6" Openings
- Integrated Blackout Shades w/ Reflective Insulation
- SoundCore Boom 2 Bluetooth Speaker (Waterproof)
- Large Folding Entry Grab Handle
- Brinkley Automotive-Grade Sealant Package
- Sleek Styling w/ Automotive-Grade Exterior Graphics
- 28"x72" Entry Door w/ Window
- Hot/Cold Outdoor Shower
- Tankless On-Demand Water Heater
- 30k BTU Furnace
- Straight Frame Chassis
- Heated & Enclosed Underbelly (Circulated Forced Air)
- Brinkley On-Command™ Docking & Utility Center
- Industry-First Brass Plumbing Fittings
- Water Shutoff Valve on All Fixtures
- Clear "No Surprises" Sewer Cap w/ Lanyard
- Industry-First Low-Maintenance Roof
- Hankook Load Range E 10-Ply Tires w/ 15" Custom Wheels
- Road Armor™ Suspension Equalizer System
- 50-Amp Electric Service (Required on 24x)
- 200W Solar Panel w/ 30-Amp Victron MPPT Solar Controller (400W Solar & Lithium Ready) + 3000W Inverter Prep
- 4-Point Manual Stabilizer Jack System (Electric Stabilizer Jack Prep)
- Demco EZ Latch Trailer Coupler

## FACTORY OPTIONS

- 62" Tri-Fold Sofa (52"x70" Sleeper) \$413
- Second 8k Furrion A/C in Bedroom \$1,113



For More Information, Photos, Videos, & Why Brinkley go to [BrinkleyRV.com](https://www.BrinkleyRV.com)