

MODEL Z 3420

Standard Run **MSRP \$140,672**

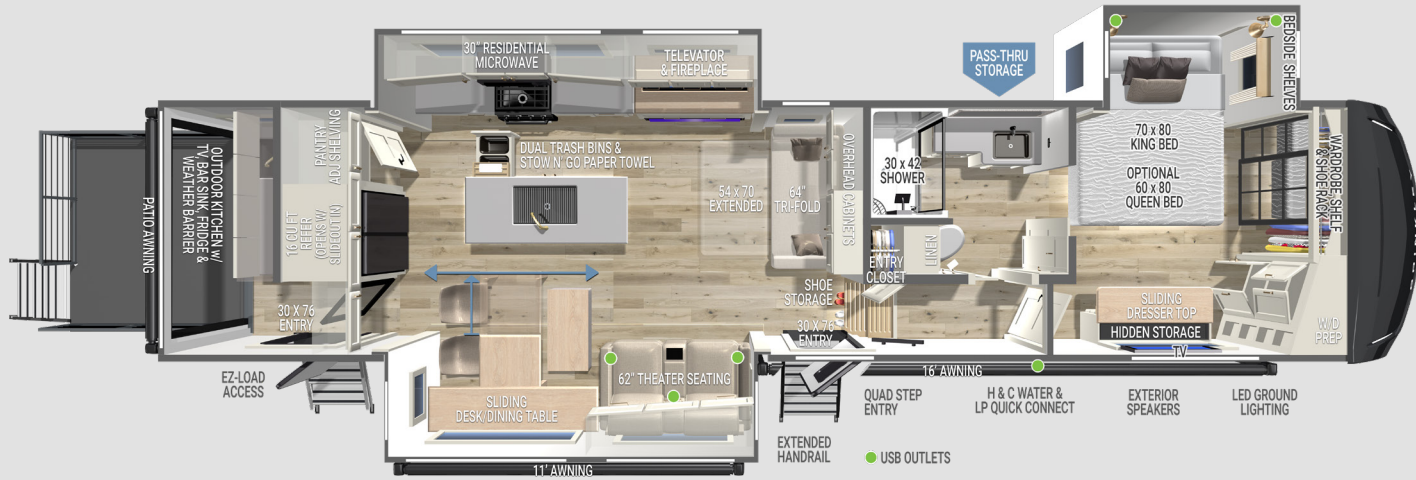

SPECIFICATIONS

- UVW: 14,691 lbs.
- GVWR: 17,695 lbs.
- Hitch Weight: 2,497 lbs.
- Exterior Length: 39' 11"
- Overall Height w/ A/C: 13' 4"
- Width: 96"
- Interior Height: 79.5"
- Slide Height: 76"
- Axles: Tandem 8,000 lbs.
- Wheels & Tires: 17.5" H-Rated (16-Ply)
- Fresh Water Capacity: 75 gal.
- Gray Water Capacity: 128 gal. (88 True + 40)
- Black Water Capacity: 44 gal.
- Insulation: Floors/Ceiling R40, Walls R11

FEATURES

- Sliding Desk/Dining Table w/ Extending Leaf (Seats Up To 4)
- Dual Pull-Out Trash Bins w/ Integrated Stow N' Go Paper Towel Holder
- 84" Pantry w/ Adjustable Shelves & Appliance Outlet
- Premium Residential Cabinets & Drawers w/ Dovetail Joints
- Brinkley CraftSense™ Wood Trim Construction
- Kitchen & Living Room/Dining Room Flush Floor Slides
- 24x+ outlets and 6x outlets w/ USB & USB-C
- 2x Furrion 18k Chill Cube A/Cs w/ Heat Pumps (Ducted to Bedroom & Bath)
- Bedside Shelves & Outlets w/ USB & USB-C
- Hidden Sliding Dresser Top Storage Compartment
- Square Euro Frameless Dual Pane Windows w/ Up To 6" Openings

- Integrated Window Screens & Insulated Blackout Blinds (No Valances)
- Rockford Fosgate Stereo w/ App Control
- Automotive-Grade Front Cap, Lights, & Lenses
- Sleek & Clean Styling w/ Automotive-Grade Exterior Graphics
- Over 130 cu. ft. of Exterior Storage w/ Tough Ply Liner
- Built-in Wire Conduit from Roof to Basement
- Electric Waste Valves w/ Indicator Light & Manual-Override
- Brinkley Platinum Smart-Command™ Center w/ Touch Screen, App Control, & 1-Touch Awning Control
- Full-Height Vertical Brake/Turn Light Strips
- Large Exterior Storage w/ Tough Ply Liner
- Industry First Brass Plumbing Connections
- Industry First Low Maintenance Roof

- 2 - Hot/Cold Outdoor Showers (BOTH sides of coach)
- Electric Waste Valves w/ Indicator Light & Manual-Override
- 370W Solar Panel w/ 50-Amp MPPT Controller (Inverter Prep & Lithium Ready)
- One Touch Automatic 6-Point Leveling System
- CURT Touring Coil Suspension System w/ Anti-Lock Braking System (ABS), Anti-Sway, & Dynamic Brake Boost
- CURT Helux™ King Pin w/ Coil Spring & Shock-Absorber

- Large 12V 3.3 cu.ft. Refrigerator (Travel Day Accessible)
- Zero-Gravity Rear Patio w/ Electric Top Latches
- Residential Style Wire Patio Railing, Power Awning w/ LED Lighting, & Steps
- Two-Sided MOLLE Panel w/ Prep Table & Cup Holders
- Push-Button Weather Barrier & Camp Side Second Entry

FACTORY OPTIONS

- Queen Bed w/ Nightstands \$428
- Gen-Y® Executive Gooseneck w/ SnapLatch Torsion Flex \$1,876
- Premium Exterior Pkg. w/ Full Body Paint (Silver, White, or Gold) \$24,000

OUTDOOR KITCHEN & PATIO HIGHLIGHTS

- 50" Smart TV on Swivel Mount
- Cabinet Storage, Work Surface, & Bar Sink

Optional equipment & props may be shown. All content is subject to change without notice. Please consult with your dealer for current information.

