



**BRINKLEY**

MODEL I, MODEL Ix & MODEL Z AIR TRAVEL TRAILERS



# WHO IS BRINKLEY RV?

Our ownership team is comprised of five equal partners representing decades of RV experience. We have a strong track record of creating and influencing some of the industry's most successful RV companies, including many of today's top-selling fifth wheel and travel trailer brands.

We've noticed a distinct shift in the RV industry in recent years and felt a sense of responsibility to our customers to re-ignite cutting-edge innovation and bring back customer-driven product designs that will raise the bar for everyone. More importantly, we saw a gradual decline in quality and

a skewed perception of what it means to take care of the customer. We are excited to prove to our customers that there is a better way. **We are passionate and committed to building high-quality RVs and servicing them like never before!** We encourage you to research us and Brinkley RV. The more you know about us, the more you'll see that we're building something different. We are relentless in our pursuit of the **ULTIMATE CUSTOMER EXPERIENCE!** We will never stop in our quest to be the best and most reputable RV manufacturer in the industry.

Thank you so much for learning more about Brinkley RV. We sincerely want to be spectacular and earn the strongest reputation in the industry. We will never quit pursuing the ultimate customer experience — **YOU HAVE OUR WORD!**

*Michael Rye 4th RV FL*  
*Donna*



## PRODUCT DESIGN

The owners of the company are responsible for product design. They are passionate about living the RV lifestyle and testing them firsthand in order to create phenomenal products. The look, the features, and the quality levels are all driven by the insights they have collected from speaking with customers, addressing problems, and using the RVs before bringing them to market. We like to live by the mentality, *"When you live the lifestyle, you become the customer."* **We started each product line by identifying all the issues that have plagued our industry for years and built the solutions into the design.** We challenged existing processes, materials, technology, and even our suppliers to deliver a better quality coach we could be proud of.

## QUALITY

Everyone talks about quality, but it is incredibly disappointing what most of our industry is delivering. We are dedicated to producing the highest quality RVs. It begins with **intelligent designs** and a steadfast **commitment to quality** throughout the organization. However, it takes robust checkpoints to confirm that we deliver on our promise. In addition to production line checkpoint inspections, each and every Brinkley undergoes a vigorous off-road simulation and a battery of testing through our PDI process, covering over 500 items before your RV ships to the dealer. We have committed a tremendous amount of time and effort on the front end to **KEEP YOU CAMPING AND OUT OF THE SERVICE SHOP!**



## TAKING CARE OF YOU, OUR CUSTOMER

**We will do what is right!** We strive for perfection, but unfortunately, problems will arise. When they do, **WE HAVE YOUR BACK** and will do what it takes to get you back on the road. We do this by supporting our dealers and working hand in hand with them regarding service to make it as seamless as possible. We are also committed to quickly and accurately expediting parts to ensure you get back on the road as soon as possible.



## PRIVATE COMPANY

We have all worked for privately held and publicly traded companies, and there are certainly benefits to both. Today, almost every RV company is publicly traded. However, when you are developing your culture, responding quickly to the market, and making decisions that impact your customers, it is a huge advantage to be private, like Brinkley RV. Sometimes even well-intentioned public RV companies are under too much pressure to create short-term gains at the expense of long-term quality and creating customers for life!

AT BRINKLEY, WE DO THINGS DIFFERENT.





For Pricing & To Learn More



THE MODEL ix LINE UNLOCKS BOLD NEW POSSIBILITIES IN THE LIGHTWEIGHT HALF-TON TOWABLE SEGMENT.

# MODEL ix

PREMIUM HALF-TON TOWABLE TRAVEL TRAILERS

## KEY FEATURES ACROSS THE MODEL i LINE

- Seamless Laminated Aluminum Exterior w/ Automotive Paint, Sleek Styling, & Premium Exterior Graphics
- Neon LED Docking Lights
- Brinkley Automotive-Grade Sealant Package w/ 3 Year Warranty
- 200W Solar Panel w/ 30 AMP Victron MPPT Controller (400W Solar & Lithium Ready)
- 40" Smart TV w/ Articulating Mount
- SoundCore Boom Bluetooth Portable Waterproof Speaker
- Magnetic Cabinet & Drawer Catches
- Dishwasher Prep
- Pull-Out Dining Table w/ Utensil Drawer
- Square Euro Frameless Windows w/ Up To 6" Openings
- Integrated Window Screens & Insulated Blackout Blinds
- Dimmable Living Room Lights
- Pet Friendly Package: 100% Carpet Free, Limited Floor Ducts, & Child/Pet Defender Screen Protector

## MODEL ix 20

UVW - 5,653 lbs.  
GVWR - 7,395 lbs.  
Hitch Weight - 525 lbs.  
Exterior Length - 23' 11"

A Compact Layout w/ 2 Sofas, Feather-Lift™ Hidden Queen Bed System, & Pull-Out Dining Table



## MODEL ix 23

UVW - 5,841 lbs.  
GVWR - 7,495 lbs.  
Hitch Weight - 556 lbs.  
Exterior Length - 26' 11"

Open Living, Pull-Out Dining Table, & Queen Bed



20x Kitchen



20x Feather-Lift™ Hidden Bed System - Sofa



Pull-Out Dining Table



Nightstand & Cubby



20x Feather-Lift™ Hidden Bed System - Queen Bed



Stow 'n Go Paper Towel Caddy & Pull-Out Trash Bin



23x Queen Bed



20x & 23x Wall Hugger Theater Seating w/ Recliners



23x Under Bed Storage

	20x	23x
UVW	5,653 lbs.	5,841 lbs.
GVWR	7,395 lbs.	7,495 lbs.
Hitch Weight	525 lbs.	556 lbs.
Exterior Length	23' 11"	26' 11"
Height w/ AC	10' 11"	10' 11"
Exterior Width	96"	96"
Ceiling Ht.	78"	78"
Slide Ht.	69"	69"
Cargo Storage (cu. ft.)	23" 5'	23" 5'
Wheels & Tires	205/75 R14 D-Rated (8-ply)	205/75 R14 D-Rated (8-ply)
Fresh Water Cap.	46 gal.	46 gal.
Grey Water Cap.	45 gal.	45 gal.
Black Water Cap.	45 gal.	45 gal.

## MODEL ix FEATURES

		20x	23x
EXTERIOR, CHASSIS & SUSPENSION	Straight Frame Chassis w/ Stabilizer Jacks (Brinkley Spec & Certified)	•	•
	Road Defense Triple Powder Coated Chassis	•	•
	Hankook Vantra 205/75 D Rated 8-Ply Tires w/ 14" Aluminum Wheels	•	•
	Galvanized Wheel Well Shields for Road Debris	•	•
	Drum Brakes w/ High-Performance Road Armor™ Suspension Equalizer	•	•
	Power Tongue Jack w/ LED Illumination & Demco EZ Latch Trailer Coupler	•	•
	StrongLite Seamless Laminated Aluminum Exterior w/ Automotive-Grade Paint, UV Protected for a Lasting Finish	•	•
	Square Euro Frameless Windows w/ Up To 6" Openings	•	•
	Sleek & Clean Styling w/ Automotive-Grade Exterior Graphics	•	•
	TuffCoat Epoxy Front Cap w/ Extended Front Rock Guard Protective Shield	•	•
ELECTRICAL & HVAC	Backup/Security Furrrion Camera Prep	•	•
	Deluxe Entrance Pkg: 28"x72" Door w/ Window, Lightweight Solid Entry Steps, Child/Pet Screen Protector, Large Folding Entry Grab Handle	•	•
	200 Watt Solar Panel (400 Watt Ready)	•	•
	30 Amp Service + 30 Amp Victron MPPT Solar Controller (Lithium Ready)	•	•
	18k BTU Chill Cube Variable Speed Air Conditioner (Main)	•	•
	Thermaflex® No Kink No Tear Heat Ducts	•	•
	Pre-Engineered & Assembled Wiring Harnesses, Loomed, Labeled, & Color Coded for Easy Serviceability (Segment-First)	•	•
	Brass Plumbing Fittings w/ Water Shutoff Valve on ALL Fixtures	•	•
	Brinkley CraftSense™ Wood Trim Construction	•	•
	Slide-In Access: Refrigerator, Bathroom, Bedroom	•	•
INTERIOR	Blackout Shades w/ Reflective Insulation + Full Bug Screens	•	•
	62" Wall Hugger Theater Seating w/ 2 Recliners	•	•
	62" Trifold Sofa w/ Scotchgard Protection	0	0
	Premium Residential Drawers w/ Dovetail Joints	•	•
KITCHEN	Residential Thermofoil Kitchen Countertop	•	•
	Pull-Out Dining Table w/ Utensil Drawer	•	•
	Stow 'n Go Paper Towel Caddy & Pull-Out Trash Bin w/ Utility Storage	•	•
	Large Pantry w/ Pull-Out Drawers & Appliance Outlet	•	•
BED & BATH	Residential 30" Convection Microwave & Dishwasher Prep	•	•
	One-Piece 36"x30" Fiberglass Shower w/ Marine Lighting	•	•
	Queen Bed w/ 7" Memory Foam Bamboo Mattress (60"x80")	•	•
	Brinkley Feather-Lift™ Hidden Bed System: Queen Bed w/ Residential 7" Feather Topper Mattress (60"x78")	•	•
CONSTRUCTION	Nightstands w/ Cubbies & Outlets w/ USB & USB-C (CPAP Ready)	•	•
	Designed & Warrantied for Full-Time RVing	•	•
	Low-Maintenance Roof	•	•
	Brinkley Automotive Exterior Seals Pkg (3 Year Warranty)	•	•
	Industry Best Insulation Package (Floor & Ceiling R40 / Walls R9) w/ Double Insulated Roof, Front Cap, & Main Floor	•	•
		• Standard	• Option

\* Length is measured from center of pin to the back wall of the coach.  
\*\* Optional equipment & props may be shown. All content is subject to change without notice. Please consult with your dealer for current information.





For Pricing &  
To Learn More



THE MODEL I LINE BRINGS THE BRINKLEY EXPERIENCE TO CUSTOMERS WITH A VARIETY OF TOW VEHICLES,  
OPENING EXCITING NEW POSSIBILITIES IN THE LUXURY LIGHTWEIGHT MARKET.

# MODEL I

PREMIUM LIGHTWEIGHT TRAVEL TRAILERS

## KEY FEATURES ACROSS THE MODEL I LINE

- Seamless Laminated Aluminum Exterior w/ Automotive Paint, Sleek Styling, & Premium Exterior Graphics
- Fiberglass Front Cap w/ Neon LED Docking Lights
- 50" Smart TV w/ Articulating Mount\*
- Dishwasher Prep
- Pull-Out Dining Table w/ Drawer (Seats up to 4)
- Electric Fireplace
- Brinkley MaxSpace Split-Level Wardrobe™ w/ Hanging Closet, Shelves, & Hamper
- 76" x 43" Picture Perfect Front Window w/ Privacy Shade
- Square Euro Frameless Windows w/ Up To 6" Openings
- Integrated Window Screens & Insulated Blackout Blinds
- Brinkley Automotive-Grade Sealant Package w/ 3 Year Warranty
- Rockford Fosgate Sound System w/ Campside Speakers
- 200W Solar Panel w/ 30 AMP Victron MPPT Controller (600W Solar & Lithium Ready) + Inverter Prep
- ABS w/ Anti-Sway & Dynamic Brake Boost

### MODEL I 235

UVW - 6,891 lbs.  
GVWR - 8,495 lbs.  
Hitch Weight - 610 lbs.  
Exterior Length - 26' 11"

*Large Bathroom,  
Pull-Out Dining Table, Electric  
Fireplace, King Bed, MaxSpace  
Split-Level Wardrobe™*



### MODEL I 265

UVW - 7,298 lbs.  
GVWR - 9,600 lbs.  
Hitch Weight - 659 lbs.  
Exterior Length - 29' 11"

*Large Rear Bathroom,  
Pull-Out Dining Table,  
Electric Fireplace, King Bed,  
MaxSpace Split-Level Wardrobe™*

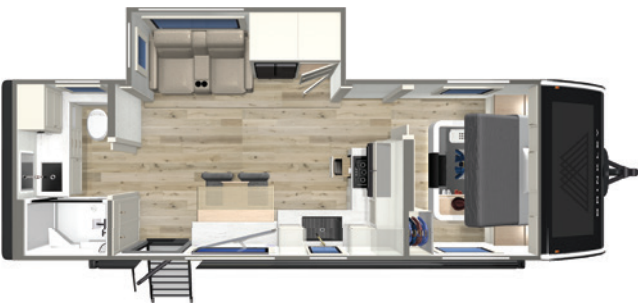

### MODEL I 275

UVW - 7,485 lbs.  
GVWR - 9,600 lbs.  
Hitch Weight - 705 lbs.  
Exterior Length - 30' 11"

*Large Bathroom,  
Rear Kitchen, Pull-Out Dining  
Table, Electric Fireplace, King Bed,  
MaxSpace Split-Level Wardrobe™*



### MODEL I 294

UVW - 8,420 lbs.  
GVWR - 10,495 lbs.  
Hitch Weight - 796 lbs.  
Exterior Length - 34' 10"

*Bunkroom, Pass-Through  
Bathroom, Pull-Out Dining  
Table, Electric Fireplace,  
King Bed, MaxSpace Split-Level  
Wardrobe™*



### MODEL I 280

UVW - 8,411 lbs.  
GVWR - 10,495 lbs.  
Hitch Weight - 776 lbs.  
Exterior Length - 32' 10"

*L-Sofa, 50" Smart TV, Convertible  
Dinesk™ Dining Table (Seats up to 4),  
Electric Fireplace, King Bed,  
MaxSpace Split-Level Wardrobe™*



280 Large Rear Kitchen



280 L-Sofa

\* Length is measured from center of pin to the back wall of the coach.  
\*\* Optional equipment & props may be shown. All content is subject to change without notice. Please consult with your dealer for current information.





275 Residential Kitchen w/ Craftsense Wood Trim Construction



Large Pantry w/ Pull-Out Drawers & Appliance Outlet



275 & 294 Wall Hugger Theater Seating w/ 2 Recliners & Trifold Sofa



294 Floor-to-Ceiling Wardrobe w/ Removable Shelf for Additional Hanging Storage



265 Spacious Rear Bathroom



235 Residential Kitchen w/ Craftsense Wood Trim Construction



265, 275, & 280 King Bed w/ 7" Memory Foam Bamboo Mattress



Brinkley MaxSpace Split-Level Wardrobe™



294 Bunkroom w/ Wardrobe



Pull-Out Trash Bin w/ Stow 'n Go Paper Towel Caddy



280 Convertible Dining Table w/ 2x Leaves



280 Convertible L-Desk w/ 2x Leaves



235, 265, 275, 294 Pull-Out Dining Table w/ Utensil Drawer

## MODEL I FEATURES

CHASSIS & SUSPENSION		235	265	275	280	294
	Fiberglass Front Cap w/ Automotive Paint & Neon LED Docking Lights	•	•	•	•	•
	Drop Frame Chassis (Brinkley Spec & Certified)	•	•	•	•	•
	Road Defense Triple Powder Coated Chassis	•	•	•	•	•
	Hankook Vantra 225/75 E Rated 10-Ply Tires w/ 15" Aluminum Wheels	•	•	•	•	•
	Banded Tire Pressure Monitoring System (TPMS) w/ Wireless Display	•	•	•	•	•
	Galvanized Wheel Well Shields for Road Debris	•	•	•	•	•
	Anti-Lock Braking System (ABS) w/ Anti-Sway & Dynamic Brake Boost	•	•	•	•	•
	High-Performance Road Armor™ Suspension Equalizer System	•	•	•	•	•
	Power Tongue Jack w/ LED Illumination & Demco EZ Latch Trailer Coupler	•	•	•	•	•
EXTERIOR & STORAGE	4-Point Power Stabilizer Jack System	•	•	•	•	•
	Upgraded 6' Coiled Breakaway Safety Cable	•	•	•	•	•
	LED Underbody Ground Lighting	•	•	•	•	•
	StrongLite Seamless Laminated Aluminum Exterior w/ Automotive-Grade Paint, UV Protected for a Lasting Finish	•	•	•	•	•
	Square Euro Frameless Windows w/ Up To 6" Openings	•	•	•	•	•
	Dual Pane Square Euro Frameless Windows w/ Up To 6" Openings	•	•	•	•	•
	Sleek & Clean Styling w/ Automotive-Grade Exterior Graphics	•	•	•	•	•
	76"x45" Picture Perfect Front Window w/ Privacy Shade	•	•	•	•	•
	Exterior Rockford Fosgate Speakers w/ Weather-Proof Enclosures	•	•	•	•	•
	Backup/Security Furrion Camera Prep	•	•	•	•	•
SOLAR, ELECTRICAL, HVAC	Front Pass-Through Storage Compartment: 2x Power Outlets, Forced-Air Heated & Insulated, Tough-Ply Floor, Thick Bulkhead Walls	•	•	•	•	•
	Rear Storage Compartment w/ Motion Lighting & Power Outlets (Heated & Insulated)	•	•	•	•	•
	Pet & Property Security Campside Tie-Down, Carpet Free & Ductless Floors	•	•	•	•	•
	Deluxe Entrance Package: 28"x72" Entry Door w/ Window, Extended Entry Latch, Screen Shot Automatic Screen Door Closer, 44" Telescoping Entry Handrail	•	•	•	•	•
	12v Refrigerator (Campside)				•	•
	26"x72" Camp Side Second Entry Door				•	•
	200 Watt Solar Panel (600 Watt Ready)	•	•	•	•	•
	30 Amp Victron MPPT Solar Controller (600W Solar & Lithium Ready)	•	•	•	•	•
	Inverter Prep (3000 Watt Ready)*	•	•	•	•	•
	18k BTU Chill Cube Variable Speed Air Conditioner (Main)	•	•	•	•	•
CONSTRUCTION	8K Air Conditioner (Bedroom)	•	•	•	•	•
	Thermaflex® No Kink No Tear Heat Ducts	•	•	•	•	•
	Pre-Engineered & Assembled Wiring Harnesses, Loomed, Labeled, & Color Coded for Easy Serviceability (Segment-First)	•	•	•	•	•
	Brass Plumbing Fittings (Industry First)	•	•	•	•	•
	Clear "No Surprises" Sewer Cap w/ Lanyard	•	•	•	•	•
	65' Retractable City Water Hose	•	•	•	•	•
	Maxxair Fan w/ Rain Sensor (Kitchen & Bathroom)	•	•	•	•	•
	Water Shutoff Valve on ALL Fixtures	•	•	•	•	•

INTERIOR		235	265	275	280	294
	Brinkley CraftSense™ Wood Trim Construction	•	•	•	•	•
	Integrated Window Screens & Insulated Blackout Shades	•	•	•	•	•
	Flush Floor Stepless Slide-Out(s)	•	•	•	•	•
	Dimmable Bedroom & Living Room Lights	•	•	•	•	•
	50" Smart TV w/ Articulating Mount	•	•	•	•	•
	Premium Rockford Fosgate Sound System w/ Bluetooth & Physical Controls	•	•	•	•	•
	62" Wall Hugger Theater Seating w/ 2 Recliners	•	•	•	•	•
	Fireplace w/ Electric Heat	•	•	•	•	•
	Trifold Sofa w/ Scotchgard Protection	•	•	•	•	•
KITCHEN	L-Sofa w/ 4x Recliners w/ Heat	•	•	•	•	•
	12 cu ft Energy Efficient 12-Volt Refrigerator + Convection Microwave	•	•	•	•	•
	Residential Solid Surface Kitchen Countertop	•	•	•	•	•
	Waterfall Island Flip-Up Countertop w/ ClearGo™ (Converts to Peninsula)					•
	Premium Residential Drawers w/ Dovetail Joints	•	•	•	•	•
	Pull-Out Dining Table w/ Utensil Drawer (2 Positions)	•	•	•	•	•
	Convertible Dinesk™ Dining Table/L-Desk w/ 2x Leaves (Seats up to 4)				•	•
	Pull-Out Trash Bin w/ Utility Storage	•	•	•	•	•
	Stow 'n Go Paper Towel Caddy	•	•	•	•	•
	Magnetic Cabinet & Drawer Catches	•	•	•	•	•
BATH	Dishwasher Prep	•	•	•	•	•
	Large Pantry w/ Pull-Out Drawers & Appliance Outlet	•	•	•	•	•
	Marine Grade Neon LED Shower Lighting	•	•	•	•	•
	One-Piece Molded Fiberglass Shower	•	•	•	•	•
	Stainless Steel Sink w/ Tuff Coat (Kitchen & Bathroom)	•	•	•	•	•
BEDROOM	King Bed w/ Residential 7" Memory Foam Bamboo Mattress (66"x80")	•	•	•	•	•
	Dual Bedside Nightstands w/ Deep Storage & Outlets w/ USB & USB-C Charing Ports (CPAP Ready)				•	•
	Dual Bedside Nightstands w/ Cubbies & Outlets w/ USB & USB-C Charing Ports (CPAP Ready)				•	•
	MaxSpace Split-Level Wardrobe™ w/ Hanging Closet, Shelves, & Hamper	•	•	•	•	•
BUNK	Stacked Rear Bunk Beds (48"x74") w/ Outlets & USB & USB-C Ports				•	•
	Floor to Ceiling Storage Cabinet w/ Drawers & Under Step Storage				•	•
	Top Bunk Window				•	•
CONSTRUCTION	Designed & Warrantied for Full-Time RVing	•	•	•	•	•
	Low-Maintenance Roof	•	•	•	•	•
	Brinkley Automotive Exterior Seals Pkg (3 Year Warranty)	•	•	•	•	•
	Reinforced & Walkable Slide Roofs	•	•	•	•	•
	Industry Best Insulation Package (Floor & Ceiling R40 / Walls R9) w/ Double Insulated Roof, Front Cap, & Main Floor	•	•	•	•	•
	Industry Leading Pre-Delivery Tests & Inspection Process	•	•	•	•	•



For Pricing &  
To Learn More



THE BRINKLEY MODEL Z AIR PREMIUM TRAVEL TRAILERS ARE A CLASS APART. WITH AN AUTOMOTIVE EXTERIOR & A RESIDENTIAL INTERIOR, THIS TRAVEL TRAILER OFFERS A UNMATCHED COMBINATION OF STYLE AND COMFORT.

# MODEL Z AIR

PREMIUM LUXURY TRAVEL TRAILERS

## KEY FEATURES ACROSS THE MODEL Z AIR LINE

- Premium Residential Drawers w/ Dovetail Joints
- Residential Solid Surface Countertops
- Brinkley CraftSense™ Wood Trim Construction
- Dishwasher Prep
- One-piece 42" x 30" Molded Fiberglass Shower w/ Seat (Low-Step/Max Height)
- Dimmable Living Room & Bedroom Lights
- Automatic One Touch 5-Point Leveling & Stabilization System w/ Hitch Height Memory
- Backup Camera & Wireless Monitor w/ Observation/Security
- LED Underbody Ground Lighting
- Exterior Speakers w/ Bluetooth & Campside Controls
- LP & Gear Box w/ Locking Tool Storage & Battery Tray
- Brinkley Automotive-Grade Sealant Package w/ 3 Year Warranty
- Sleek Styling w/ Automotive-Grade Exterior Graphics
- 370 Watt Solar Panel (740 Watt Ready) + 50 Amp MPPT Solar Controller (Inverter Prep & Lithium Ready)

## MODEL Z AIR 297

UVW - 10,297 lbs.  
GVWR - 13,495 lbs.  
Hitch Weight - 924 lbs.  
Exterior Length - 34' 11"

*Gourmet Kitchen, Queen Bed,  
Fireplace in Bedroom, Washer/  
Dryer Prep*



## MODEL Z AIR 315

UVW - 11,569 lbs.  
GVWR - 14,495 lbs.  
Hitch Weight - 1,105 lbs.  
Exterior Length - 38' 5"

*Spacious Bunkroom, Gourmet  
Kitchen, Queen Bed, Fireplace in  
Bedroom, Washer/Dryer Prep*



## MODEL Z AIR 310

UVW - 11,061 lbs.  
GVWR - 14,495 lbs.  
Hitch Weight - 1,062 lbs  
Exterior Length - 37' 10"

*Gourmet Kitchen, Queen w/  
Nightstands, King Optional, &  
Lots of Storage, Washer/Dryer Prep*



315 Living Room & Kitchen w/ Craftsense Wood Trim Construction



315 Bunk Room w/ a Sofa Bed, 2 Bunks, Smart TV & Wardrobe



315 Bunk Room Sofa Bed



315 Sleeper Dinette & Wall Hugger Theater Seating

\* Length is measured from center of pin to the back wall of the coach.

\*\* Optional equipment & props may be shown. All content is subject to change without notice. Please consult with your dealer for current information.





297 & 310 Living Room & Kitchen w/ Craftsense Wood Trim Construction



297 & 310 Large Pantry w/ Adjustable Shelves & Appliance Outlet



297 & 310 Brinkley Z Dinesk™: Sliding Desk/Dining Table w/ Automatic Extending Leaves



Bathroom Vanity & Backlit Mirror



297 & 315 Bedroom w/ Queen Bed



297 & 315 Under-Bed Storage w/ Lockable In-Floor Steel Safe



310 Bedroom w/ King Bed & Wardrobe



Fully Finished Dovetail Drawers



310 Sliding Dresser Top Hidden Storage



315 Outdoor Kitchen



297 & 310 Rear Storage



42" Smart TV & Televator  
& Electric Fireplace



Convenience Center w/  
65" Retractable Hose

## MODEL Z AIR FEATURES

CHASSIS		297	310	315
CHASSIS	Drop Frame Chassis (Brinkley Spec & Certified)	•	•	•
	Road Defense Triple Powder Coated Chassis	•	•	•
	Premium Hankook Vantra 235/80 Load Range G 14-Ply Tires	•	•	•
	16" Custom Aluminum Luxury Wheels	•	•	•
	Galvanized Wheel Well Shields for Road Debris	•	•	•
	Anti-Lock Braking System (ABS) w/ Anti-Sway & Dynamic Brake Boost	•	•	•
	Banded Tire Pressure Monitoring System (TPMS) w/ Wireless Display	•	•	•
	Automatic One Touch 5-Point Leveling & Stabilization System w/ Hitch Height Memory	•	•	•
	Demco EZ Latch Trailer Coupler + Upgraded 6' Coiled Breakaway Safety Cable	•	•	•
	High-Performance Road Armor™ Suspension Equalizer System	•	•	•
EXTERIOR & STORAGE	LED Underbody Ground Lighting	•	•	•
	Automotive Front Cap, Lights, & Lenses	•	•	•
	Square Euro Frameless Windows w/ Up To 6" Openings	•	•	•
	Dual Pane Square Euro Frameless Windows w/ Up To 6" Openings	0	0	0
	Sleek & Clean Styling w/ Automotive-Grade Exterior Graphics	•	•	•
	Exterior Speakers w/ Bluetooth	•	•	•
	Backup Camera & Wireless Monitor w/ Observation/Security Mode	•	•	•
	Front Pass-Through Storage: 4x Power Outlets, Forced-Air Heated & Insulated	•	•	•
	Rear Storage Compartment: Motion Lighting, Forced-Air Heated & Insulated	•	•	•
	Outdoor Kitchen w/ Sink, Prep Surface, Overhead Cabinet Storage, Drawers, & 110v 4.3 Cu Ft Fridge	•	•	•
	Clear "No Surprises" Sewer Cap w/ Lanyard	•	•	•
	Deluxe Entrance Door Package: 30"x76" Door, Keyless Entry, Integrated Window Shade, Screen Defender, Screen Shot Screen Door Opener, Screen Assist, Extra-Wide & Deep Solid Entry Steps, 54" Telescoping Entry Handrail	•	•	•
	Custom LP & Gear Box w/ Locking Tool Storage & Battery Tray	•	•	•
SOLAR, ELECTRICAL & HVAC	370 Watt Solar Panel (740 Watt Ready)	•	•	•
	50 Amp MPPT Solar Controller (Inverter Prep & Lithium Ready)	•	•	•
	18k BTU Rear Furrion Chill Cube Air Conditioner w/ Heat Pump (2x)	•	•	•
	8K Air Conditioner in Bunkroom	•	•	•
	Thermaflex® No Kink No Tear Heat Ducts	•	•	•
	Wiring Harnesses, Loomed, Labeled, & Color Coded for Easy Serviceability	•	•	•
	Wire Conduit for Aftermarket Upgrades	•	•	•
	Industry First Brass Plumbing Fittings	•	•	•
	Electric Waste Valves w/ Indicator Light & Manual-Override (Enclosed & Heated)	•	•	•
	65' Retractable City Water Hose	•	•	•
	Washer/Dryer Prep	•	•	•
	2x 30 lbs. LP/Propane Tanks	•	•	•
	Maxxair Fan w/ Rain Sensor (Kitchen & Bedroom)	•	•	•
	LP-IQ Propane Gauge	•	•	•

INTERIOR		297	310	315
INTERIOR	Brinkley CraftSense™ Wood Trim Construction	•	•	•
	Integrated Window Day Screens, Insulated Blackout Blinds & Full Bug Screens	•	•	•
	DUAL Flush Floor Galley & Living Room Slides (Segment First)	•	•	•
	Wall Hugger Theater Seating w/ Heat & Wireless Charging (2x Recliners)	•	•	•
	Dimmable Living Room & Bedroom Lights	•	•	•
	Soft-Close Cabinet Doors & Drawers	•	•	•
	42" Smart TV & Televator (Powered TV Elevator)	•	•	•
	Pet-Friendly Package: Exterior Pet & Property Security Tie-Down, Magnetic Pet Feeder w/ Removable Bowls, Carpet Free & Ductless Floors	•	•	•
	Brinkley Smart-Command™ Center w/ App Control	•	•	•
	Premium Residential Soft Close Cabinet Doors & Drawers	•	•	•
KITCHEN	Residential Solid Surface Countertops Throughout	•	•	•
	Pull-Out Trash Bin(s) & Stow 'N Go Paper Towel Caddy	•	•	•
	Fridge Accessible w/ Slides-In	•	•	•
	Large Pantry w/ Adjustable Shelves & Appliance Outlet	•	•	•
	One-Piece Steel Island Base w/ Indirect Mood Light	•	•	•
	Brinkley Z Dinesk™: Sliding Desk/Dining Table w/ Automatic Extending Leaves & Storage Drawer (4 Position)	•	•	•
	Sleeper Dinette w/ Storage Drawer & Indirect Mood Lighting	•	•	•
BATH	Marine Grade Neon LED Shower Lighting	•	•	•
	One-Piece 42"x30" Molded Fiberglass Shower w/ Seat (Low-Step/Max Height)	•	•	•
	Toilet Paper Caddy w/ Magnetic Travel Keeper	•	•	•
BEDROOM	Queen Bed w/ Residential 7" Memory Foam Mattress (60"x80")	•	•	•
	King Bed w/ Residential 7" Memory Foam Mattress (70"x80") *No Cost	•	0	•
	Under-Bed Storage Space w/ Lockable In-Floor Steel Safe	•	•	•
	Dual Motion Activated LED Bed Lights	•	•	•
	Dual Bedside Storage Cubbies w/ Outlets & USB & USB-C (CPAP Ready)	•	•	•
	Fireplace w/ 5,000 BTU Electric Heat	•	•	•
BUNKROOM	Sofa Bed (58"x72")	•	•	•
	Overhead Flip Bunk (32"x72")	•	•	•
	Top Bunk (44"x76")	•	•	•
	42" Smart TV w/ Wardrobe	•	•	•
CONSTRUCTION & WARRANTY	Designed & Warrantied for Full-Time RVing	•	•	•
	Low-Maintenance Roof	•	•	•
	Brinkley Automotive Exterior Seals Pkg (3 Year Warranty)	•	•	•
	Bedroom Slim Rack Slide System	•	•	•
	Loomed, Labeled, & Color Coded Wiring Harness	•	•	•
	Water Shutoff Valve on ALL Fixtures	•	•	•
	Industry Best Insulation Package	•	•	•
	Industry Leading Pre-Delivery Tests & Inspection Process	•	•	•

	297	310	315
UVW	10,297 lbs.	11,061 lbs.	11,569 lbs.
GVWR	13,495 lbs.	14,495 lbs.	14,495 lbs.
Hitch Weight	924 lbs.	1,062 lbs.	1,105 lbs.
Exterior Length	34' 11"	37' 10"	38' 5"
Height w/ AC	11' 9"	11' 9"	11' 9"
Exterior Width	96"	96"	96"
Ceiling Ht.	84"	84"	84"
Slide Ht.	72.5"	72.5"	72.5"
Cargo Storage (cu. ft.)	60+	60+	55+
Wheels & Tires	235/80 R16 G-Rated (14-ply)	235/80 R16 G-Rated (14-ply)	235/80 R16 G-Rated (14-ply)
Fresh Water Cap.	62 gal.	62 gal.	62 gal.
Grey Water True Cap.	75 (45+30)	105 (30+45+30)	105 (30+45+30)
Black Water Cap.	45 gal.	45 gal.	45 gal.





Premium Hankook Vantra Tires



Clear "No Surprises" Sewer Cap w/ Lanyard



Z AIR Pass Thru Storage  
in Bathroom/Bedroom



Residential Hardware

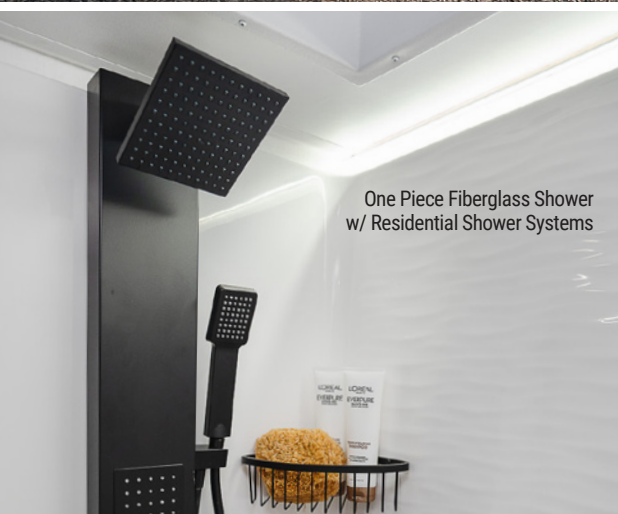

One Piece Fiberglass Shower  
w/ Residential Shower Systems

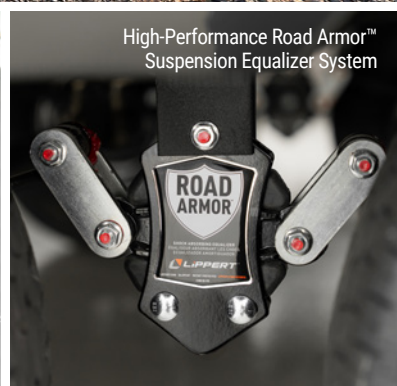

High-Performance Road Armor™  
Suspension Equalizer System



Forced-Air Heated & Insulated Pass-Through  
Storage w/ Tough-Ply Floor



Square Frameless Euro Windows Open Up To 6" +  
Sleek & Clean Styling w/ Automotive-Grade Exterior Graphics



Maxxair Fan w/ Rain Sensor

I & Ix Seamless Laminated Aluminum Exterior:  
Euramax StrongLite Laminated Aluminum,  
Automotive-Grade Paint,  
UV Protected for a Lasting Finish



I & Ix Power Tongue Jack w/  
LED Illumination & Demco EZ  
Latch Trailer Coupler



Z AIR, I & Ix Lightweight  
Solid Entry Steps



Ix On-Command™ Docking & Utility Center



Premium Drawers w/ Dovetail Joints



Exterior Pet & Property Security  
Tie-Down, 100% Carpet Free,  
Child/Pet Defender Screen Protector



I 294 Rear Storage

## QUALITY & CONSTRUCTION YOU CAN COUNT ON

- 1-Year Bumper-to-Bumper Transferable Warranty
- 3-Year Structural Warranty
- Warrantied for Full Time RVing
- 1-Year No Questions & 5-Year Limited Tire Warranty
- 20-Year Roof Membrane Warranty & 25-Year Seal Warranty
- Complimentary 24/7 Roadside Assistance (12 Months)
- Brass Plumbing Fittings & Water Shutoff Valves on ALL Fixtures
- Brinkley Automotive-Grade Seals Package
- 3-Year Limited Internal Seals & Gasket Warranty
- Low-Maintenance Roof
- Reinforced & Walkable Slide Roofs
- Pre-Engineered & Assembled Wiring Harnesses, Loomed, Labeled, & Color Coded for Easy Serviceability
- Industry Best Insulation Package
- Industry Leading Pre-Delivery Tests:
  - 350+ Point Inspection & Testing
  - Road Simulation Tested (Industry Exclusive)
  - Complete Unit Pressure Test (Seals, Gaskets, Slideout, Etc.)
  - Performed on Every Coach Every Time
- Industry's Best Customer Care Team with a "Make it Right" Attitude
- Owners Hub Featuring Model Specific How To Videos



EXPLORE  
THE LINE-UP



## MODEL I & Ix

### PREMIUM LIGHTWEIGHT TRAVEL TRAILERS

Brinkley's Model I and Ix lines bring the signature Brinkley experience to customers with smaller tow vehicles—opening up exciting new opportunities in the luxury lightweight market. From the Model Ix to the Model G, Brinkley's DNA is unmistakable, with a residential feel and meticulous attention to every detail.



## MODEL Z AIR

### PREMIUM LUXURY TRAVEL TRAILERS

Whether you're a weekend camper or a full-time RVer, the Z AIR is designed to impress. With features and amenities that appeal to every kind of camping enthusiast, it sets a new standard in its category. The Z AIR combines unmatched fit and finish with high-end features rarely seen in travel trailers—delivering a premium experience.



## MODEL Z

### LUXURY MID-SIZED FIFTH WHEELS

The Brinkley Model Z – Mid-Sized Luxury Fifth Wheel is in a class of its own. Its automotive exterior and residential interior deliver a no-compromise blend of style and comfort. Transforming the RV ownership experience, the Model Z makes every journey feel like home.



## MODEL G & Gx

### LUXURY FIFTH WHEEL TOY HAULERS

Developed & tested by RVers to create a Toy Hauler Without Compromise. The G line is packed with intelligently designed features, an automotive exterior, and a true residential interior that's unmatched. No matter what your adventure, Model G and Gx give you the space and capacity to explore it.

121025

# BRINKLEY

1655 Brinkley Way East, Goshen, IN 46528 | [BrinkleyRV.com](https://BrinkleyRV.com)

(888)502-3460 | Sales (574)501-4285 | Brinkley Care (574)501-4280



For Pricing &  
To Learn More



[BrinkleyRV.com](https://BrinkleyRV.com)